

DRY AGE CABINET 138L

€1,935.00

SKU:

7455.1950

Meet our Dry Age cabinet, designed for the perfect aging of meat in professional environments!



This stylish black dry age cabinet offers the ideal temperature and humidity for the dry aging process, with a glass door for excellent product presentation. The LED lighting ensures optimal illumination of your products. The user-friendly control panel allows precise temperature adjustments, while the forced cooling system maintains a stable environment. The humidity level of 65-85% creates perfect aging conditions. The modern, stylish black finish makes the cabinet a real eye-catcher in any professional setting.

Dimensions: 600x500x900 mm (LxDxH) - Power consumption: 0.235 kW - Capacity: 138 liters - Temperature: 0/+10°C - Relative humidity: 65-85% - Weight: 50 kg

Key features:

- **Forced cooling:** ensures constant temperature and humidity for dry aging.
- **LED lighting:** presents your products in the best light, energy-efficient and effective.
- **Humidity of 65-85%:** creates ideal aging conditions.
- **Robust and professional appearance:** perfect for premium meat display in retail or horeca environments.
- **Stylish black design:** modern finish that beautifully accentuates your products.

Make a statement in your store or restaurant and provide your meat with the perfect aging conditions. Order the Dry Age cabinet today and add a luxury element to your assortment!



CombiSteel



Width (mm)	600	Depth (mm)	500
Height (mm)	900	Material	Stainless steel Aisi 304
Material interior	Stainless steel 304	Color	Black
Parcel ready	No	Gross Weight (kg)	50
Particulars	Maximum hanger loading 115 kg	Voltage (Volt)	230
Frequency (Hz)	50	Electrical power (kW)	0,235
Model tabletop/ freestanding/drop-in	Freestanding	Cooling agent	R 600 A
Temperature range (°C)	0/+10	Number of grids	1
Gross Capacity (Ltr)	138	Dim. interior WxDxH (mm)	510x355x745
Operation	Digital	Temperature display	Yes, digital
Lights	Yes, LED	Type of cooling	Ventilated
Lockable	Yes	Mobile	No
Number of doors	1	Door left / right hinging	Right hinged
Noise level (dB)	45	Defrost	Automatic
Max. ambient temperature (°C)	32	Relative humidity (%)	65-85
Energy label	C	Power consumption (Kw/24h)	1,39
Brand	COMBISTEEL	Refrigerant quantity (gr)	40
Plug and play (EU only)	Yes		

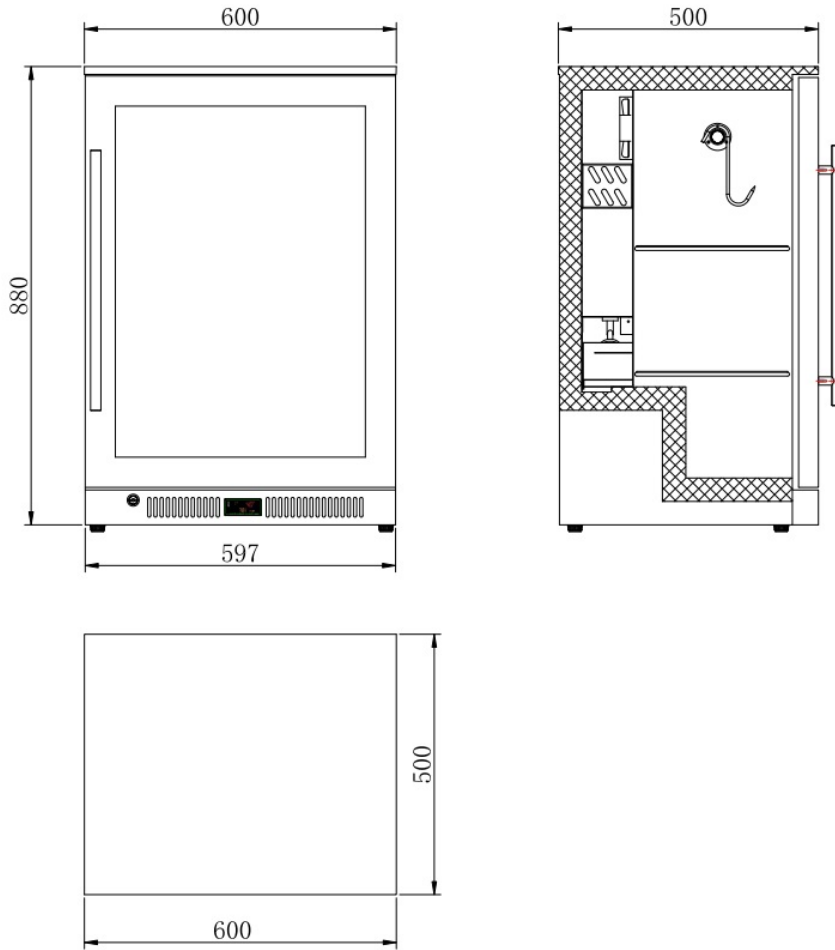



ENERG



Combisteel

7455.1950



3865 kWh/annum

0,29 m²

 **8°C**
1°C

2019/2018