

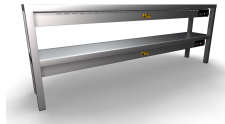

**OVERSHELF CERAMIC HEATED 2 LEVELS
1800 10 HEATERS OF 250W**

€1,835.00

SKU: 7020.0750





| | | | |
|-------------------------|-----------------|-----------------------|------------|
| EAN code | 7435137878827 | Width (mm) | 1800 |
| Depth (mm) | 300 | Height (mm) | 650 |
| Material | Stainless steel | Parcel ready | No |
| Gross Weight (kg) | 30 | Voltage (Volt) | 2x 230 |
| Frequency (Hz) | 50 | Electrical power (kW) | 2X 1,25 |
| Number of elements | 10x 250W | Brand | COMBISTEEL |
| Plug and play (EU only) | Yes | | |

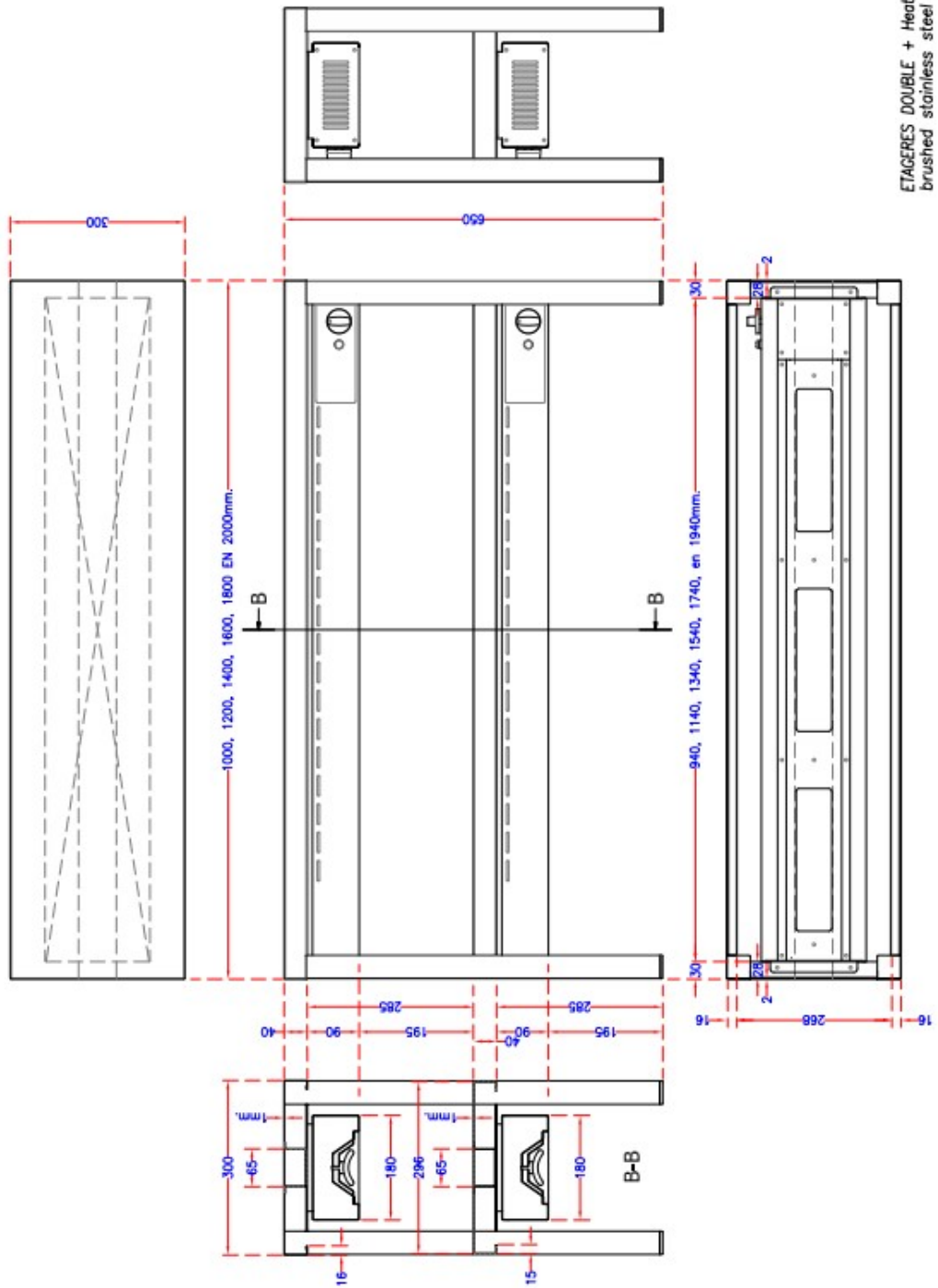

ETAGERES DOUBLE + Heat strips
brushed stainless steel 1mm.