



7455.2435

R290

Onderdelen informatie
Erzatzteil information
Spare part information
Information de pièces



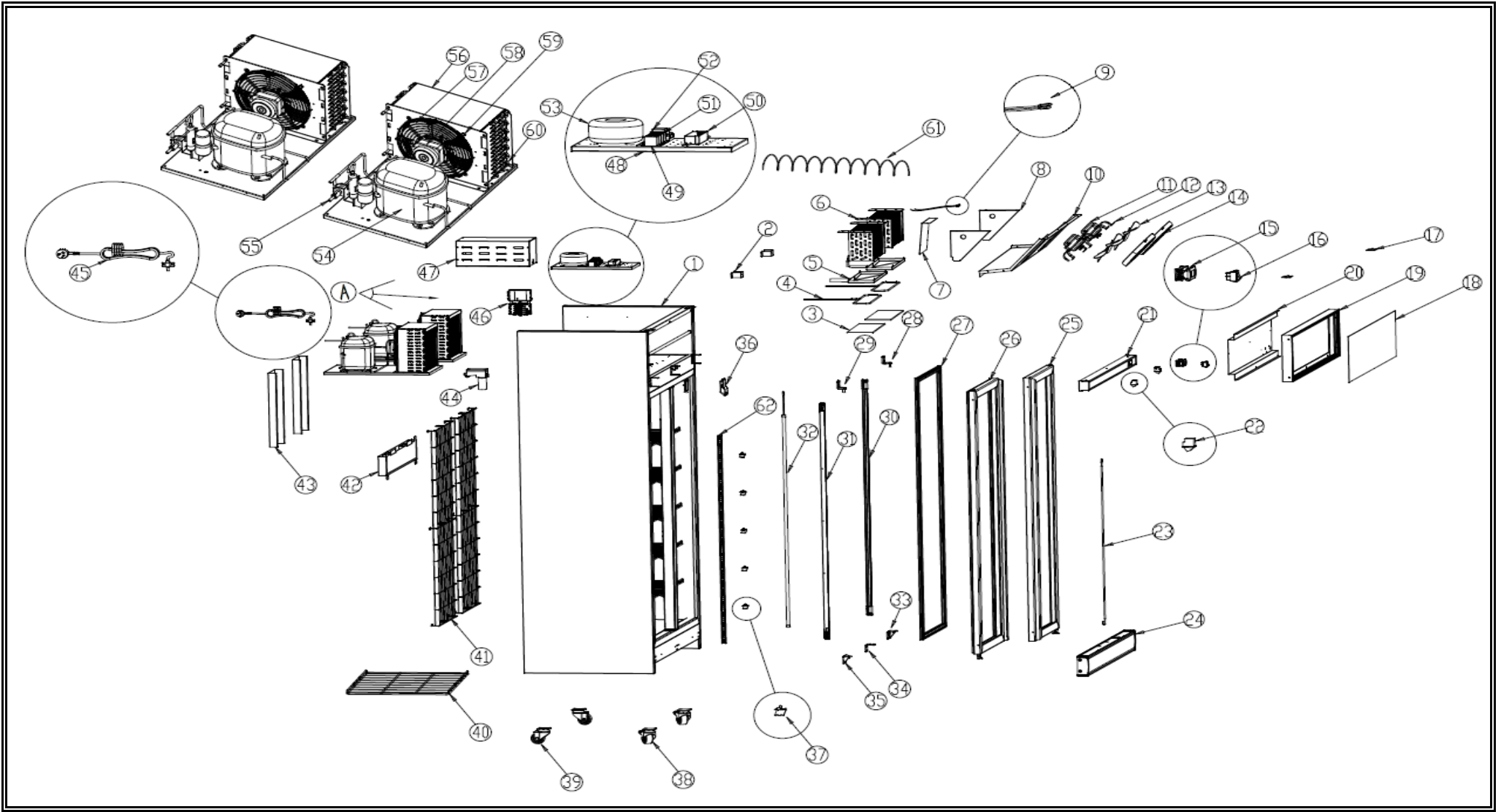

| POS: | Art.No.: | Omschrijving: | Aantal: |
|------|-----------|--------------------------------|---------|
| 1 | | Cabinet body | 1 |
| 2 | | Supporter for evaporator cover | 2 |
| 3 | | PE adhesive sticker | 2 |
| 4 | | Water tray heater pipe | 2 |
| 5 | | Evaporator water tray | 2 |
| 6 | | Evaporator | 2 |
| 7 | | Evaporator panel | 1 |
| 8 | | Evaporator end panel | 2 |
| 9 | | Temperature sensor | 1 |
| 10 | | Evaporator fan cover panel | 1 |
| 11 | 9390.1425 | Evaporator fan motor | 2 |
| 12 | | Supporter of fan motor | 16 |
| 13 | 9338.1885 | Evaporator fan blade | 2 |
| 14 | | Evaporator fan cover | 2 |
| 15 | 9338.2324 | Digital controller | 1 |
| 16 | 9030.0510 | Light switch | 1 |
| 17 | | S/S support | 2 |
| 18 | 9338.2436 | Perspex cover | 1 |
| 19 | 9338.2434 | Canopy | 1 |
| 20 | | Light installation panel | 1 |
| 21 | | Top decoration panel | 1 |
| 22 | | Fan switch | 3 |
| 23 | | Torsion spring | 3 |
| 24 | | Bottom front grill | 1 |
| 25 | | Side door | 2 |
| 26 | | Middle door | 1 |
| 27 | 9338.2306 | Door sealer | 3 |
| 28 | 9338.2314 | Right top hinge | 2 |
| 29 | 9338.2310 | Left top hinge | 1 |
| 30 | 9338.2264 | Right LED light | 1 |
| 31 | 9338.2260 | Left LED light | 1 |
| 32 | 9338.2262 | Middle LED light | 2 |
| 33 | | Right bottom hinge | 2 |
| 34 | | Door supporter | 2 |
| 35 | | Left bottom hinge | 1 |
| 36 | | Mullion wire cover | 2 |
| 37 | 9338.1905 | K clip | 65 |
| 38 | | Braked castor | 3 |
| 39 | | Unbraked castor | 3 |
| 40 | | Shelf 2 sides | 10 |
| 40A | | Shelf middle | 5 |
| 41 | | Back partition | 3 |
| 42 | | Back water tray | 1 |

| POS: | Art.No.: | Omschrijving: | Aantal: |
|------|-----------|-----------------------------|---------|
| 43 | | Cover for part of condenser | 2 |
| 44 | | Air pressure balanced valve | 1 |
| 45 | | Power cable | 1 |
| 46 | | Wiring box | 1 |
| 47 | | Box cover | 1 |
| 48 | | Electrical support panel | 1 |
| 49 | | Relay | 1 |
| 50 | 9338.2254 | LED driver | 1 |
| 51 | 9338.2286 | Transformer for controller | 1 |
| 52 | | Relay | 3 |
| 53 | | Transformer for glass door | 1 |
| 54 | 9338.3430 | Compressor | 2 |
| 55 | | Solenoid valve | 2 |
| 56 | | Condenser fan motor cover | 2 |
| 57 | 9338.1855 | Condenser fan blade | 2 |
| 58 | 9390.0130 | Condenser fan motor | 2 |
| 59 | | Condenser fan cover | 2 |
| 60 | | Condenser | 2 |
| 61 | | Capillary | 0,0823 |
| 62 | | K strip | 12 |