

USER'S INSTRUCTIONS



valid for item ref. 1S.2402.xx.S3

Bench-mount mixing faucet with spout for Professional Kitchens

English

INSTALLATION INSTRUCTIONS

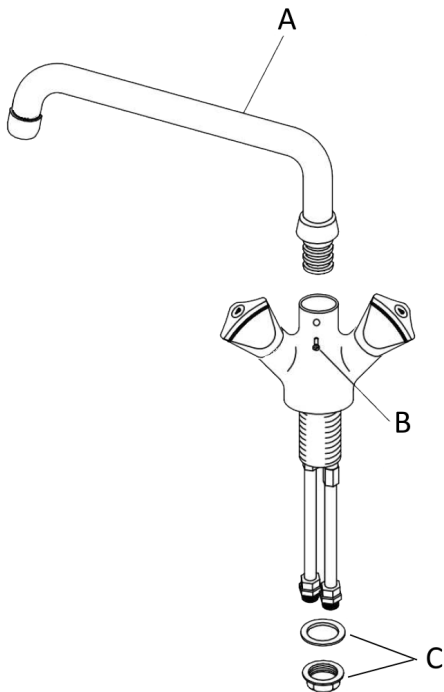

INSTALLATION

- 1) remove the screw of the faucet (B)
- 2) insert the connection of the spout in the faucet (a)
- 3) tighten the fixing screw (B) again
- 4) remove the washers and the lock nuts (C) from the threaded fixing shaft
- 5) insert the threaded shaft in the installation surface hole
- 6) fix the faucet to the installation surface using the washers and the lock nuts (C)
- 7) connect the inlet pipes to the water net

Operating parameters:

Water output from the spout 26 l./min. at 0,3 Mpa

Maximum water temperature and pressure: < 85° and < 1 Mpa

Recommended water temperature and pressure: < 65° and < 0,5 Mpa

USE:

- Do not move swivel nozzle violently and do not hang anything on the nozzle
- Keep the faucet's surfaces clean and dry using a soft cloth, in order to prevent limestone or corrosive substances fouling (do not use aggressive and/or corrosive detergents)
- Remove the aerator often and keep it clean with suitable solvents and water
- Faucet is suitable for use with water only, do not mix water with other substances

CLEANING INSTRUCTIONS

- DO NOT clean the faucet surfaces when hot. They should be cleaned when they are at room temperature
- DO NOT use aggressive and / or corrosive detergents
- DO NOT use abrasive cleaning pads
- After cleaning with soft detergent rinse well the surfaces with cold water to remove any traces of chemicals and dry them with a soft cloth.
- Avoid contact between detergents and rubber gaskets